

Compatible with any smartphone, including Android devices, iPod Touch, iPhone, iPad running Android or iOS

- Download and install the UCsmart Home App available for either iOS or Android.



iOS



Android

- Once downloaded, the App will ask you to Register your device. Enter your cellphone number and select country and you will receive a text with the registration code.



- Input the Registration Code you received via text and proceed to login.

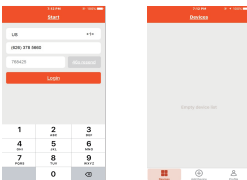

Adding a New Device

- Press and hold the On/Off smart button for 5 seconds until it flashes.
- Open App and click Add device.
- Select Wifi network > Connect and Click Next.

- Once connected the app will prompt the connection > Click OK.

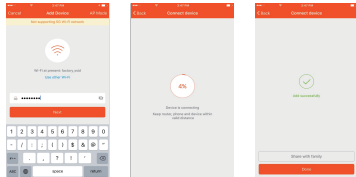

Hotspot Mode

- Press "Hotspot Mode" on the App
- Reset Device: Press and hold the On/Off smart button for 5 seconds until it flashes.
- Press "Connect" - Device name is "SmartLife-XXXX" Password is 888888888 (9 * 8)
- Confirm Device.

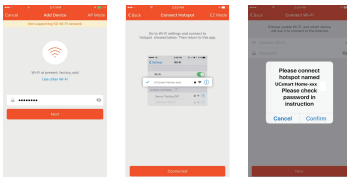
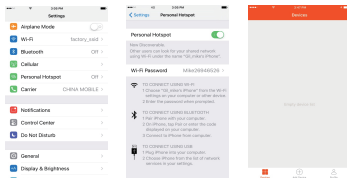

Turn On/Off via App - The almighty Power Button

- Click "UCsmart Home" in the main menu.
- Press Power Button to turn plus On / Off.

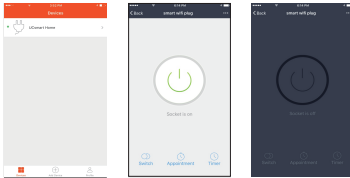

Device Functions - Basic Controls and Usage

- Main Menu
- Select Switch / Appointment of Timer setting.

Appointment - Make sure your friends have access when they need it!

- Click the "Appointment" function to set the plug to a timer of your choice.
- Click Confirm Setting or hit back to Exit

Timer - Control your home or office remotely

- Click the "Timer" function to set time schedule and press "Add Timer"
- Set Time/Date for your desired time schedule.
- Click "Confirm" to save timer setting or hit back to exit.

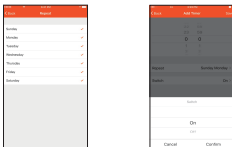
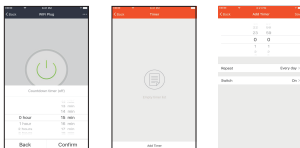

Profile - Username and info setup

- Click the "Profile" function in the main menu to open Device Sharing and Message Center .

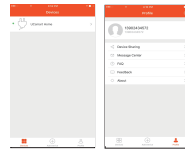

Device Sharing - Sharing Control of the Smart Plug Device

- Select "Device Sharing" in Profile and press "Add Sharing"
- Input the cellphone number of the device you want to share control with.
- Add Nickname or Username
- Press Confirm once selected.
- Device will automatically appear in "Devices Sharing" once added.

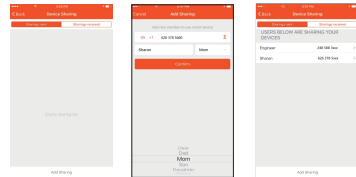

Wi-Fi Power Plug

Working voltage: AC 110~240V

Max power: 2000W (resistance loading)

Working current: Max 15A

Material: ABS flame retardant polymer

Plug Standard: US

Power consuming: ≤0.3W

Working temperature: -20 ~ 45°C (-4 ~ 113°F)

Working Humidity: ≤80%

Radio signal power: 1mW

Radio protocol: Wi-Fi

Radio rate: 30 meter indoor (signal may be blocked building materials and structures.)

Radio rate: 50 meter outdoor (signal may be blocked building materials and structures.)

Features:

* Adopt WiFi protocol to secure the success of wireless two way communication

* Higher RF output power (+2.5dBm output power as compared to -2.5dBm 300 series WiFi module) to enhance the communication range

* Very low electricity consumption, meet Europe year 2012 energy-related products requirement directive 2009/125/EC no. 1275/2008

* Overload protection

* Voltage, Current, Power factor, Instant power Wattage and Accumulated power consumption KWh report