

PROTECTION THAT LIVES ON
MICROBAN® Series
 Premium 6-setting Showerhead

Items: 5502 (Green Jets), 5503 (Purple Jets), 5504 (Blue Jets)

To Install

1. Remove old shower head by turning it counter-clockwise. Remove any excess material left on Shower Arm threads. Use steel wool if necessary.
2. Make sure Mesh Washer is positioned FLAT and STRAIGHT inside Connection Nut (Fig. 1). Hand tighten Connection Nut onto Shower Arm (Fig. 2).

WARNING: DO NOT OVERTIGHTEN Connection Nut as it may cause Washer to dislocate and be squeezed into Shower Arm. If leakage occurs, see below.

Have a Leak? Make your shower leak-free in less than a minute!

Leakage between Connection Nut and your Shower Arm is often caused by Washer inside Connection Nut not pressing evenly against edge of Shower Arm Thread (fig. 3). This is usually the result of Washer not nested correctly. To seal properly, Washer must stay FLAT and STRAIGHT inside Connection Nut (Fig. 3).

You can eliminate this leak by simply re-positioning Washer:

Unscrew Shower Head from Shower Arm and adjust position of Washer by pushing it down and pressing around its edges with your finger or pointed tool, until it nests completely FLAT and STRAIGHT inside Nut (fig. 3).

If Washer is positioned correctly but leak remains, it is likely the result of Damaged Washer Surface or Worn Shower Arm Threads. If you suspect Damaged Washer Surface, using screwdriver or pointed metal tool, gently pull out Washer from Connection Nut, turn it up-side-down and nest back into Nut. If the leak is caused by Worn Shower Arm Threads, wrap some Plumber's Tape around Shower Arm threads.

IMPORTANT: Hand tighten connection ONLY. DO NOT use wrench or pliers.

DO NOT overtighten - this may cause washer to bend and be pushed into shower arm. Use plumber's tape ONLY if Washer fails to stop leakage.

NOTE: If your shower arm has a ball on the end of it instead of thread, it will not work with this shower unit and will need to be replaced with a standard shower arm available at most plumbing supply stores.

INSTALLATION/USE INSTRUCTIONS

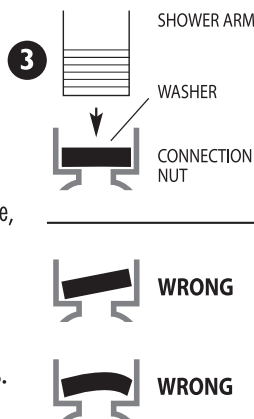
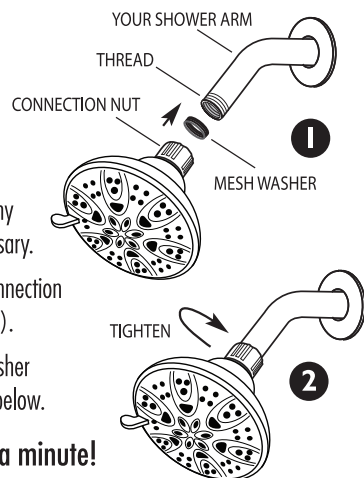

To Set 6 Shower Head Settings and Change Angle

Turn Dial Lever (Fig. 4) to select desired water pattern while holding Shower Head with free hand to prevent loosening of its connection. Swivel Shower Head around ball joint to set desired angle.

Use Pause Mode to Save Water

For your protection, Pause mode doesn't shut off water completely.

For safety (to prevent pressure buildup), Pause mode has water dripping instead of complete shut-off (Fig. 5). After use, DO NOT leave Shower Head dial set to Pause mode.

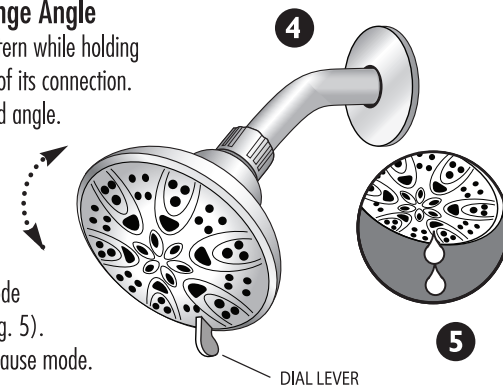

Extra-low Water Pressure? You can remove Flow Regulator.

As mandated by U.S. federal law, this shower head is equipped with water flow regulator that limits maximum water flow to 2.5 gallons (9.5 liters) per minute at 80 psi water pressure. In areas with extremely low water pressure causing the shower water flow to be unsatisfactory, the flow regulator may be removed to improve the water flow in the shower head. Using screwdriver point or long nose pliers, pull out Water Regulator located deep inside Nut underneath Mesh Washer (Fig. 6).

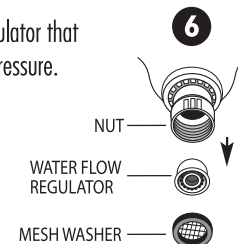

Cleaning Instructions

Cleaning maybe required when mineral deposits appear on jet tips. Clean flexible nozzles by rubbing with a finger or soft bristled toothbrush, or clean with 50% white vinegar/water solution. Do not clean or rinse any part with harsh chemicals, heavy-duty cleaners or abrasives. This may damage parts or finish and may void warranty.

If you have installation problem or missing parts, please DO NOT return this product before calling us first. We can help on the phone or by quickly sending needed parts.

For Questions/Part Replacement Call Toll Free

1-888-869-4010

Monday - Friday 9:00 AM - 4:00 PM Eastern Time

www.ipshowers.com

LIMITED LIFETIME WARRANTY

Interlink will repair or replace any of this product's parts that exhibit defects in workmanship or materials for above stated period from date of purchase. If malfunction occurs, send only defective part(s) with proof of purchase to Customer Service Department at the address listed below. This warranty does not cover product purchased from unauthorized distributors, malfunction or damage due to accident, misuse, use of harsh chemicals or failure to follow any included written instructions. This warranty gives you specific legal rights. You may also have other rights that vary where you reside.